

DISTRICT	COUNTY	ROUTE	SECTION	SHEET	
11-0	ALLEGHENY	4037	XXX	1 OF 2	
SEWICKLEY, SEWICKLEY HEIGHTS & EDGEWORTH BOROUGHS					
REVISION NUMBER	REVISIONS			DATE	BY

# SR 4037 - WAY HOLLOW ROAD

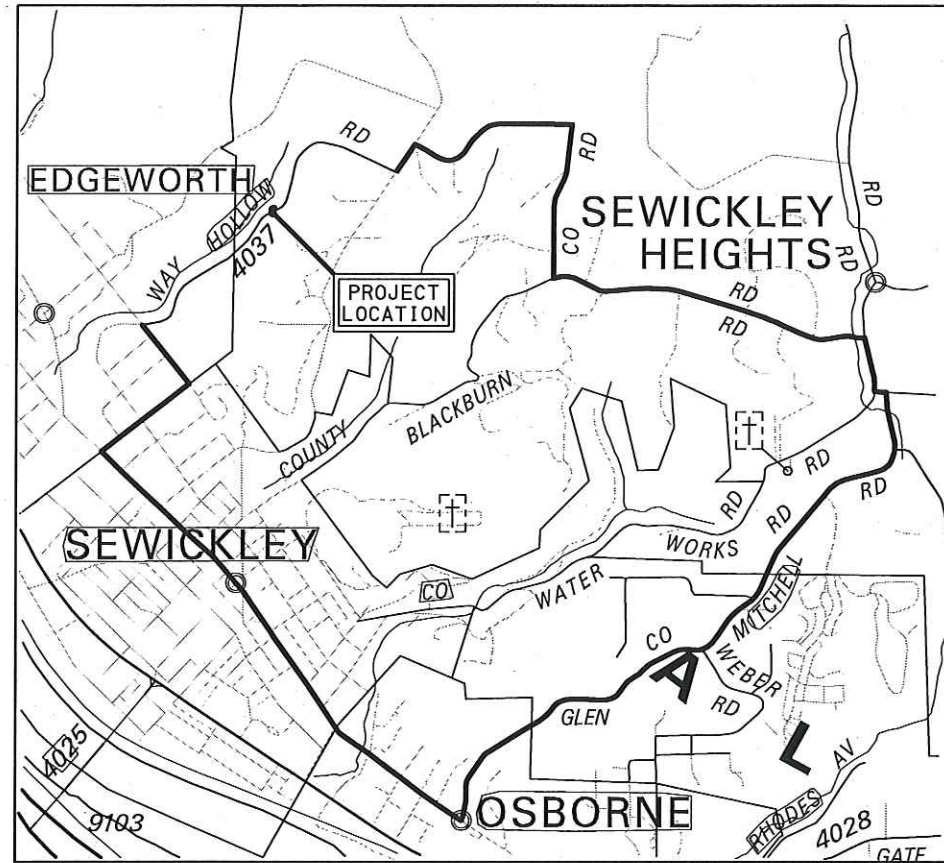

NOT TO SCALE

DETOUR LENGTH APPROX. 7 MILES

## GENERAL NOTES

THIS WORK CONSISTS OF MAINTENANCE OF THE EXISTING DETOUR ROUTE AND THE MAINTENANCE OF TRAFFIC AND THE PROTECTION OF THE TRAVELING PUBLIC APPROACHING THE CONSTRUCTION AREA AND WITHIN THE LIMITS OF CONSTRUCTION.

MAINTAIN EXISTING TRAFFIC CONTROL DETOUR SIGNAGE AND MAINTAIN TRAFFIC DURING HOURS OF CONSTRUCTION AND AT ALL OTHER TIMES IN ACCORDANCE WITH THE METHODS INDICATED ON THESE DRAWINGS AND,

1. THE SPECIAL PROVISIONS OF THE CONTRACT.
2. PA CODE, TITLE 67, CHAPTER 212, OFFICIAL TRAFFIC CONTROL DEVICES, (MARCH 2006).
3. PDT PUBLICATION 213, TEMPORARY TRAFFIC CONTROL GUIDELINES, (JUNE 2014).
4. PDT PUBLICATION 35, APPROVED CONSTRUCTION MATERIALS (BULLETIN 15), (CURRENT REVISION).
5. PDT PUBLICATION 408, SPECIFICATIONS, DATED 2016.
6. PDT PUBLICATION 236, HANDBOOK OF APPROVED SIGNS, (NOVEMBER 2013).
7. PDT PUBLICATION 111, TRAFFIC CONTROL-PAVEMENT MARKINGS AND SIGNING STANDARDS, TC-8600 AND TC-8700 SERIES.
8. MANUAL ON UNIFORM TRAFFIC CONTROL DEVICES (MUTCD), (2009 EDITION).

IMMEDIATELY UPON COMPLETION OF THE WORK, REMOVE SIGNS AND DEVICES. FOR TYPE "B" AND TYPE "C" MOUNTED SIGNS, REMOVE POSTS COMPLETELY. RETURN ALL EXISTING SIGNAGE TO THE DEPARTMENT.

THE TRAFFIC CONTROL PLAN DOES NOT RELIEVE THE CONTRACTOR OF ITS RESPONSIBILITY AS SPECIFIED IN SECTION 901.3(d) OF PENNDOT PUBLICATION 408.

SIGN LOCATIONS MAY BE ADJUSTED SLIGHTLY TO FIT FIELD CONDITIONS.

ALL ADDITIONAL SIGNS AND DEVICES TO BE NEW WHEN INSTALLED. ALL SIGNAGE TO BE MAINTAINED IN NEW CONDITION AND TO PENNDOT'S SATISFACTION THROUGHOUT THE DURATION OF THE PROJECT.

THESE PLANS HAVE BEEN REVIEWED AND ARE IN COMPLIANCE WITH STANDARDS PRESCRIBED IN CHAPTER 212 OF THE 67 PA. CODE AS CURRENTLY AMENDED.

NOTE THAT THIS APPROVAL DOES NOT RELIEVE THE CONTRACTOR OF THE RESPONSIBILITY FOR THE PROTECTION OF THE PUBLIC AND THE CONSTRUCTION PERSONNEL. THE STANDARDS PRESCRIBED ARE MINIMUM AND ADDITIONAL PROTECTION MAY BE NECESSARY IF PROBLEMS ARE ENCOUNTERED DURING THE TERM OF THE CONTRACT. CONSTANTLY REVIEW THIS PLAN FOR ADEQUACY AND RECOMMEND CHANGES FOR DEPARTMENT APPROVAL WHEN INADEQUACIES ARE DISCOVERED.

THE CONTRACTOR HAS THE OPTION TO SUBMIT ALTERNATE TRAFFIC CONTROL PLANS FOR CONSIDERATION. THESE PLANS SHALL BE SIGNED AND SEALED BY A PROFESSIONAL ENGINEER REGISTERED IN THE COMMONWEALTH OF PENNSYLVANIA, AND SHALL BE CONSISTENT WITH STANDARD DESIGN PRACTICES. THE DEPARTMENT WILL ALLOW NO CONSTRUCTION ACTIVITY UNTIL THE CONTRACTOR'S ALTERNATE PLANS ARE APPROVED IN WRITING BY THE DISTRICT TRAFFIC ENGINEER. MODIFICATIONS TO THE APPROVED MPT PLAN SHALL BE APPROVED BY THE DISTRICT TRAFFIC ENGINEER OR AUTHORIZED REPRESENTATIVE.

THE CONTRACTOR TO HAVE A SUFFICIENT AMOUNT OF THE FOLLOWING SIGNS AVAILABLE IN CASE THEIR USE BECOMES NECESSARY: W3-4 "BE PREPARED TO STOP" AND W20-7 "FLAGGER SYMBOL". THESE SIGNS ARE NOT INTENDED TO BE PART OF THE REQUIRED NORMAL TRAFFIC CONTROL OR A SUPPLEMENT THERETO.

REPORT ALL TRAFFIC INCIDENTS WITHIN THE PROJECT LIMITS TO THE DISTRICT TRAFFIC ENGINEER BY COPY OF THE TRAFFIC ACCIDENT REPORT FROM THE PA STATE POLICE AND LOCAL POLICE.

THE CONTRACTOR IS RESPONSIBLE FOR CONTACTING THE PA ONE-CALL SYSTEM, INC. AT 1-800-242-1776 AT LEAST THREE DAYS (3) WORKING DAYS PRIOR TO DIGGING. PA ONE-CALL SHOULD BE CONTACTED BEFORE ANY SIGN POST ANCHOR IS DRIVEN INTO THE GROUND FOR ANY TEMPORARY AND/OR PERMANENT SIGNING.

## TABLE OF CONTENTS

1. GENERAL NOTES
2. DETOUR MAP / SIGN DETAILS

JST 7-10-20

DISTRICT 11-0  
TRAFFIC UNIT



TODD MICHAEL KRAVITS, P.E.  
DISTRICT TRAFFIC ENGINEER

DATE: 11-10-20 20

TRAFFIC CONTROL PLAN



DISTRICT	COUNTY	ROUTE	SECTION	SHEET
11-0	ALLEGHENY	4037	XXX	2 OF 2
SEWICKLEY, SEWICKLEY HEIGHTS & EDGEWORTH BOROUGHS				
REVISION NUMBER	REVISIONS	DATE	BY	

PLOTTED: 09-JAN-2020 14:46

D-9012 CAD (02-90) REVISED (10-04)

OPERATOR: FOLAKE OWOLAJA FILE NAME: C:\Users\stowal\OneDrive - Commonwealth of Pennsylvania\Traffic\TrafficPlan.dgn

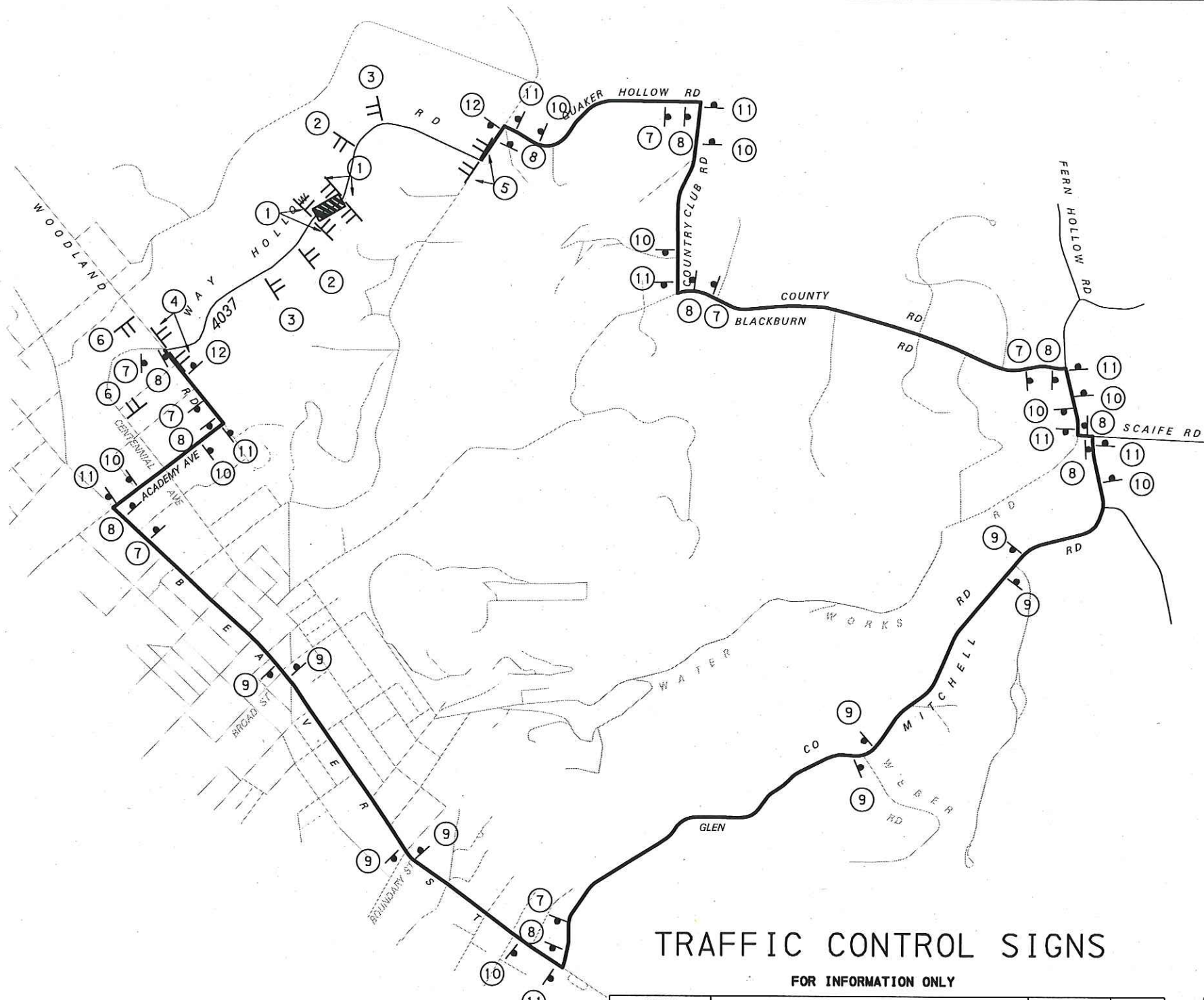

### TRAFFIC CONTROL SIGNS FOR INFORMATION ONLY

SIGN DESIGNATION	DESCRIPTION	SIZE	MIN QTY
R11-2	ROAD CLOSED	48"X30"	4
R11-3A	ROAD CLOSED AHEAD - LOCAL TRAFFIC ONLY	60"X30"	4
W20-2	ADVANCE DETOUR	36"X36"	2
M4-10R	DETOUR ARROW, RIGHT	48"X18"	4
M4-8A	END DETOUR	24"X18"	2
M4-9S	DETOUR, STRAIGHT	30"X24"	8
M4-9R	DETOUR, RIGHT	30"X24"	10
M4-9L	DETOUR, LEFT	30"X24"	9
M4-9SL	LEFT ADVANCE DETOUR	30"X24"	8
M4-9SR	RIGHT ADVANCE DETOUR	30"X24"	7
W20-3	ADVANCE ROAD CLOSED	36"X36"	4

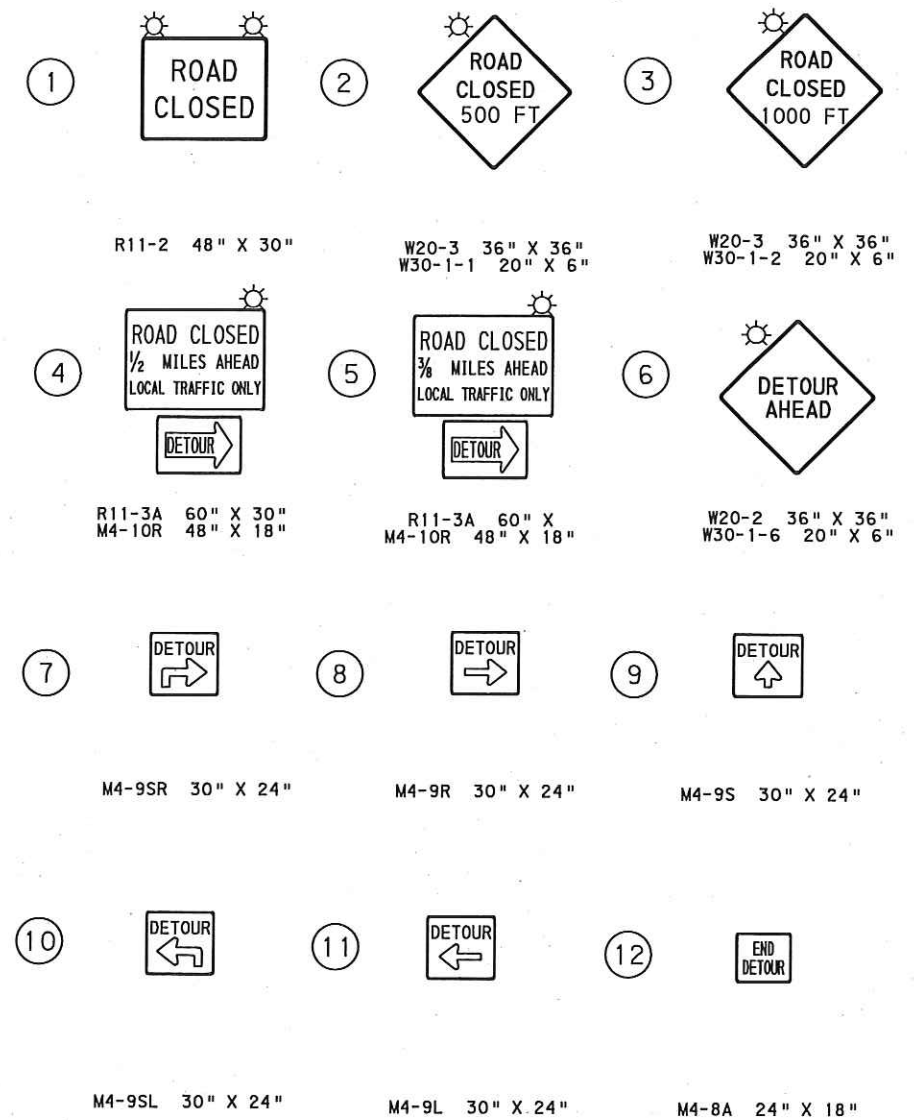

### TRAFFIC CONTROL SIGNS (CONTINUED)

SIGN DESIGNATION	DESCRIPTION	SIZE	MIN QTY
W30-1-1	500 FT - DISTANCE PANEL	20"X6"	2
W30-1-2	1000 FT - DISTANCE PANEL	20"X6"	2
W30-1-6	AHEAD - DISTANCE PANEL	20"X6"	2

**LEGEND**

	PROJECT LOCATION
	DETOUR ROUTE
	POST MOUNTED SIGN
	TYPE III BARRICADE
	SIGN NUMBER

NOT TO SCALE

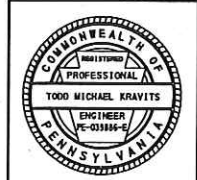

DETOUR MAP/SIGN DETAILS

### TRAFFIC CONTROL PLAN